

**SITE PLAN**

CLARIDON TOWNSHIP, GEauga COUNTY, OHIO

for: DENNIS BALANTE  
CLIENT OWNER

ADDRESS	STREET	CITY	ZIP
SUBDIVISION	NAME	LOT	TRACT
		14	HOLMES
VOL. - PG.		914	824
SUBLOT NO.	STREET	VOLUME	PAGE
			TAYLOR WELLS
		PERM. PARCEL NO.	STREET

**LEGEND**

SANITARY MANHOLE	---	○	WATER VALVE (GAS)	---	+
STORM MANHOLE	---	●	WATER METER (GAS)	---	+
INLET OR CATCH BASIN	---	■	AS BUILT ELEVATION	---	100.0
HYDRANT	---	⊕	INDICATES DIRECTION OF SURFACE DRAINAGE	---	↓
EXISTING CONTOURS	---	---			
PROPOSED CONTOURS	---	---			
EXIST. ELEV.	---	100.0	PROP. ELEV.	---	100.0

**REMARKS**

ALL BOUNDARY DATA SHOWN WAS OBTAINED FROM (DEEDS, RECORDED SUBDIVISION PLAT OR OTHER PUBLIC RECORDS)  
LOCATIONS AS SHOWN OF ADJACENT WELLS AND SEPTIC TANKS OBTAINED FROM LAKE COUNTY HEALTH DEPARTMENT

**DESIGN CERTIFICATION**

THIS PLAT WAS PREPARED BY ME, AND IS CORRECT TO THE BEST OF MY KNOWLEDGE AND BELIEF.

NAME: Dennis Balante SURVEYOR REGISTRATION NO. 4343

**CHECK LIST**

NO. OF BEDROOMS	WATER MAIN SIZE, LOCATION
DIMENSIONS	SAN. SEWER SIZE % GR. LOC.
BEARINGS	SAN. MH. CAST. ELEV. INV. ELEV.
TIE TO NEAREST STREET	SAN. CONN. SIZE, LOC. DEPTH
SUBLOT NO. PARCEL NO.	STORM SEWER SIZE % GR. LOC.
SURROUNDING OWNERS	STORM MH. CAST. ELEV. INV. ELEV.
BLDG. DIMENSIONS FIN. GR.	PAVT TYPE GRADE CURBS
APRON TYPE WIDTH THICKNESS	GAS LINE LOC. SIZE PRESSURE
SIDEWALK TYPE WIDTH THICKNESS	SEPTIC TANK LOCATION & DUPLICATION AREA
CULVERT TYPE DIA., LENGTH	WELL LOCATION
ROCK OUTCROPPINGS	ISOLATION RADIUS FROM WELL

**REVISIONS**

NO.	DATE	BY	PLAN PREPARED BY:
1	8/16/94	HT	BABCOCK • JONES & ASSOCIATES, INC. PAINESVILLE, OHIO
2	8/25/94	HT	
3	9/2/94	HT	
4	11/2/94	HT	
5	2/14/95	HT	

DRAWN BY	SCALE	PHONE NO.
HT	1" = 200'	357-1811
CHK'D.	DATE	DRAWING NO.
HT	8/14/94	94-181
CREW CHIEF	APP'D.	
WB	HT	

I, HEREBY CERTIFY THAT THE CIRCLED GRADES ARE EXISTING FINISH GRADES CHECKED IN THE FIELD ON \_\_\_\_\_, 19\_\_\_\_ AND ARE CORRECT TO THE BEST OF MY KNOWLEDGE AND BELIEF.

REGISTERED SURVEYOR \_\_\_\_\_ REG. NO. \_\_\_\_\_

MICHELE BALANTE  
VOL. 985-PG. 1205

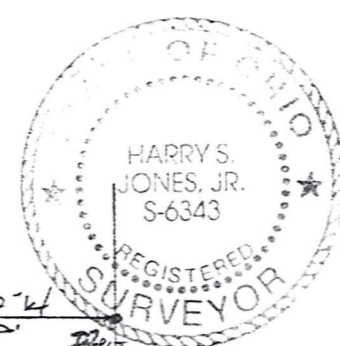
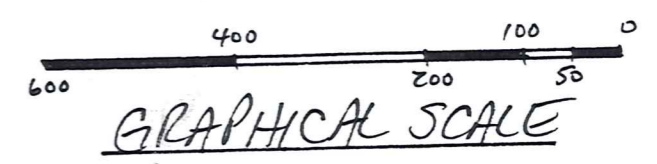

SURVEY PLAT & LEGAL DESCRIPTION  
APPROVED PER R.C. 315.251  
R.S. \_\_\_\_\_ 4/20/99  
OFFICE OF THE  
GEAUGA COUNTY ENGINEER

This map was prepared and the premises surveyed in accordance with chapter 4733-37 of the Ohio Administrative Code.



CLA00007

Balante / Bates  
picked up

# BABCOCK - JONES & ASSOCIATES, INC.

CIVIL ENGINEERS AND SURVEYORS

12-090301

1924 MENTOR AVE., PAINESVILLE, OHIO 44077    PHONE (440) 357-1811    FACSIMILE (440) 357-9173

April 5, 1999

LEGAL DESCRIPTION OF ADDITIONAL 100 FEET STRIP OF PROPERTY FOR DENNIS BALANTE TO TRANSFER TO MR. & MRS. BATES.

Situated in the Township of Claridon Township, County of Geauga and State of Ohio and known as being a part of Lot No. 14, Holmes Tract in said Township and being further bounded and described as follows;

Beginning at an iron pin found at the southeasterly corner of land conveyed to D.L. and L.L. Bates by deed recorded in Volume 1038, Page 22 of Geauga County Deed Records;

COURSE I:            Thence North 20°00'00" East along the easterly line of D.L. and L.L. Bates a distance of 193.44 feet to an iron pin found;

COURSE II:           Thence South 89°30'15" East a distance of 100.00 feet to an iron pin set;

COURSE III:          Thence South 20°00'00" West a distance of 193.44 feet to an iron pin set;

COURSE IV:          Thence North 89°30'15" West a distance of 100.00 feet to the place of beginning and containing 0.419 of an acre of land as surveyed and described by Harry S. Jones, Registered Surveyor No. 6343 in April, 1999.

Previous deed - Dennis Balante Volume 914, Page 824.

Bearings are based upon the centerline of Taylor Wells Road being South 20°00'00" West and are used to describe angles only.

SURVEY PLAT & LEGAL DESCRIPTION  
APPROVED PER R.C. 315.251

APR 5 1999

R.S.

4/20/99

OFFICE OF THE  
GEAUGA COUNTY ENGINEER